

# FROZEN UNCARBONATED BEVERAGES (FUB)

## SMALL PARTS QUICK REFERENCE GUIDE



### NEED A SMALL PART REPLACEMENT?

Dispensing equipment has several parts that you should know. See below to help you better understand your dispenser or if you need help from your Coca-Cola service provider.

#### Tray Base, Covers and Cords

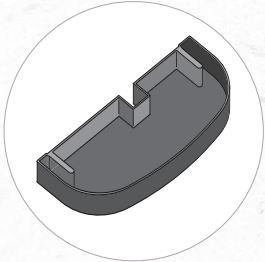

Drip Tray Base  
Part #1145585

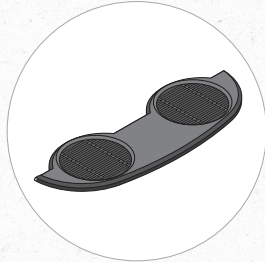

Drip Tray Cover  
Part #1145514

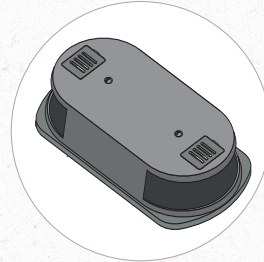

Hopper Cover  
Part #141950 (2)  
Part #1145583 (NX)

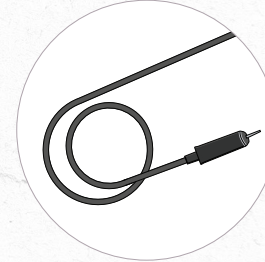

Lamp Cord  
Part #122607 (2 only)

#### Faucet & Materials

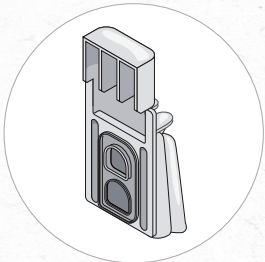

Faucet  
Part #117869 (2 only)



Faucet Handle, Extended  
Part #144757 (2)  
Part #1145518 (NX)

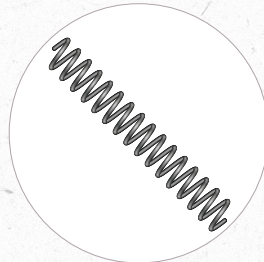

Faucet Spring  
Part #117866

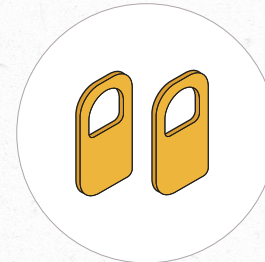

Faucet Seals, Two  
Part #127447

#### Hopper & Components

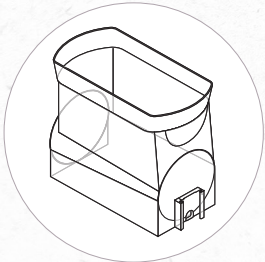

Hopper  
Part #119140 (2)  
Part #1145586 (NX)

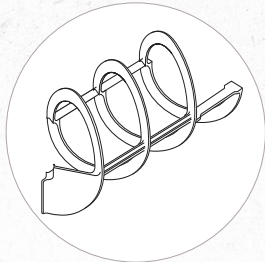

Auger  
Part #119138

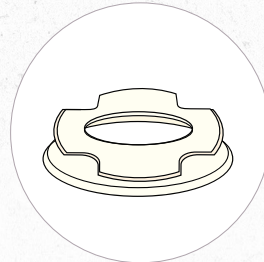

Auger Nose Bushing  
Part #117870



Auger Bushing  
Part #124100

#### Seals and additional tools

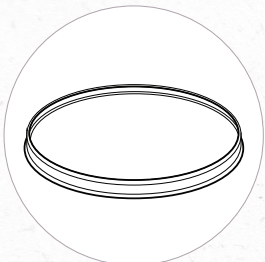

Hopper Seal  
Part # 1145517

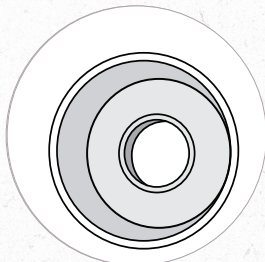

Auger Shaft Seal  
Part #117864

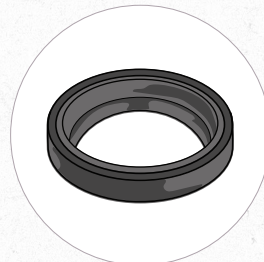

Drum to Shaft Seal  
Part #1145516

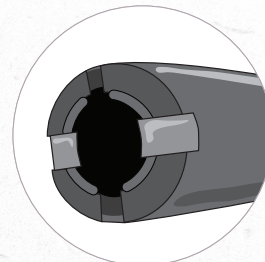

Drum to Shaft Seal Tool  
Part #1145540

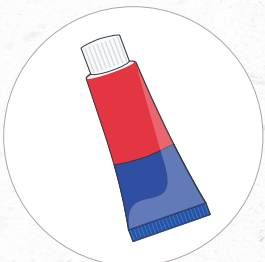

Lubrifilm Tube  
Part #148012

**NEED ASSISTANCE?** The myCoketech Team is here to help.  
Go to [myCoke.com/ESPortal](https://myCoke.com/ESPortal) or call/text 1-800-241-COKE (2653)

