

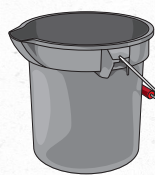

VARIETY TEA TOWER CLEANING & SANITIZATION PROCEDURES

TOOLS YOU WILL NEED:



Clean 3 Gallon Bucket



Approved Sanitizer

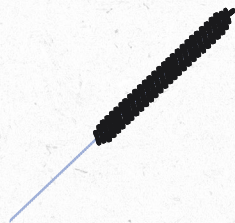

Nozzle Brush



Clean Cloths



Clean Empty Spray Bottle

! IMPORTANT: DO NOT run nozzles, drip pan or other small parts through a dishwasher and DO NOT USE HOT WATER or BLEACH.

Daily Cleaning the Dispensing Valves

! IMPORTANT turn the key to the **OFF** position or unplug dispenser before cleaning.



1 Wash hands with soap and water, and prepare approved sanitizer in a clean bucket.

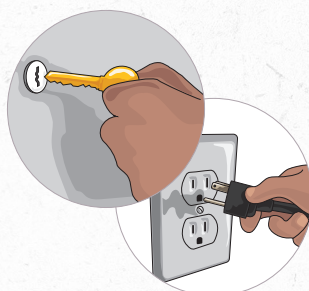

2 Unplug dispenser or turn key to **OFF** position depending on model.

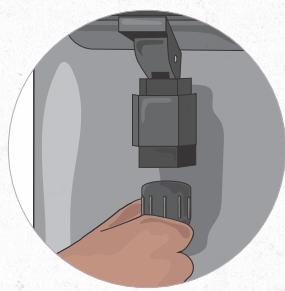

3 Remove nozzle from dispenser valve.

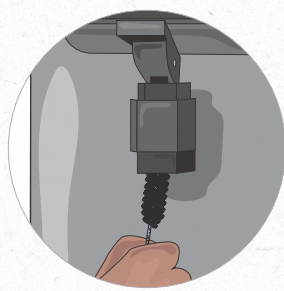

4 Scrub the diffuser with the nozzle brush and sanitizer until any buildup is removed.



5 Clean in approved sanitizer with nozzle brush.

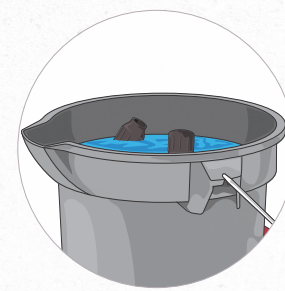

6 Place in approved sanitizer for at least 3 minutes.



7 Remove nozzle from approved sanitizer and let air dry.

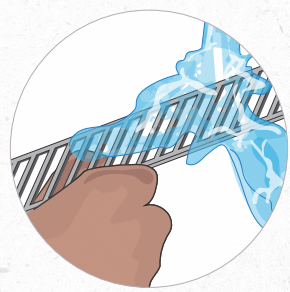

8 Remove cup rest and rinse in warm water and let air dry.



9 Wash hands with soap and water.

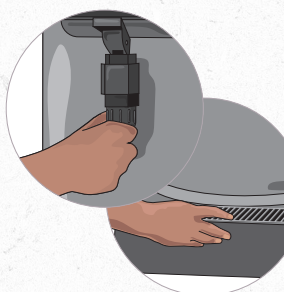

10 Reinstall nozzle, cup rest and drip tray.

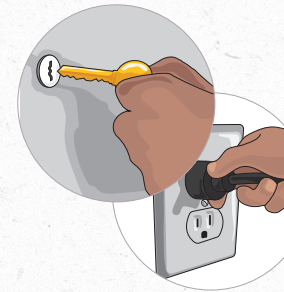

11 Plug in dispenser or turn key to **ON** position depending on model.



12 Dispense a beverage to confirm operation and taste.

Cleaning the Tower Drain



1 If drip tray is connected to a drain line, then pour 1/2 gallon of approved sanitizer over cup rest and down the drip pan drain.



2 Remove rack, wipe down the drip pan with a clean cloth and approved sanitizer.



1 Spray down surface of the dispenser with approved sanitizer solution.



IMPORTANT
Do not get any sanitizer on product selection panel.



2 Wipe down all exterior components with a clean, dry cloth.

Weekly Cleaning the Syrup Connectors

! It is **OK** to soak multiple connectors at the same time, if they are marked with a flavor label.



1 Wash hands with soap and water, and prepare approved sanitizer in a clean bucket.



2 Disconnect syrup line from the bag-in-box (BIB).

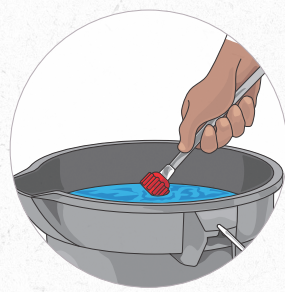

3 Soak all connectors in approved sanitizer for at least 1 minute.

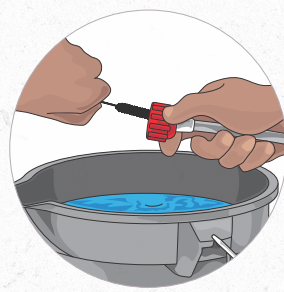

4 Scrub connectors while they soak in approved sanitizer.

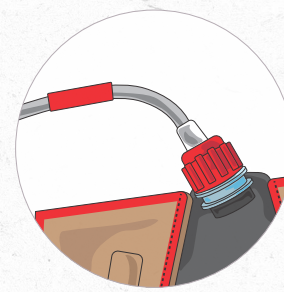

5 Shake BIB connector and reconnect to the correct BIB.

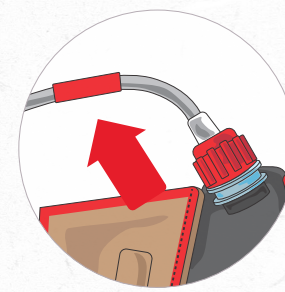

6 Check the line to verify the correct brand line tape is attached, and replace line tape if necessary.

NEED ASSISTANCE? The myCoketech Team is here to help.
Go to myCoke.com/ESPortal or call/text 1-800-241-COKE (2653)

